

CURTIS
SEC. 23, T23N, R17W
SCALE
0 0.1 0.2 0.3 0.4 0.5 MILE
0 660 1320 2640 FEET

LEGEND

<ul style="list-style-type: none"> U.S. NUMBERED HIGHWAY STATE NUMBERED HIGHWAY INTERSTATE HIGHWAY ROUTE PAVED ROAD GRAVEL ROAD GRADED & DRAINED ROAD UNIMPROVED ROAD PRIMITIVE ROAD PROJECTED ROAD RESIDENTIAL ROAD COUNTY ROAD ID NO. MILEAGE BETWEEN POINTS DIVIDED HIGHWAY, 4 OR MORE LANES UNDIVIDED HIGHWAY, 3 OR MORE LANES TRAFFIC CIRCLE HIGHWAY GRADE SEPARATION TRAFFIC INTERCHANGE STATE LINE COUNTY LINE CIVIL TOWNSHIP LINE SECTION LINE RURAL DEVELOPMENT AREA GOVERNMENT PROPERTY LINE MATCH LINE TOWN CENTER CORPORATE LIMITS CIVIL TOWNSHIP, ROAD IN PLACE INSET BOUNDARY 	<ul style="list-style-type: none"> RAILROAD WITH STATION INDICATED GRADE CROSSING UNDERPASS, R.R. ABOVE OVERPASS, R.R. BELOW RAILROAD ON STREET MILITARY AIRFIELD AIRPORT WITH COMPLETE FACILITIES AIRPORT WITH LIMITED FACILITIES LANDING STRIP, PRIVATE FIELD AIRPORT, GENERAL OUTLINE OF FIELD RUNWAYS SHOWN IN POSITION ROADSIDE PARK PLAYGROUNDS BATHING BEACH OR SWIMMING POOL SCENIC SITE CAMP SITE MOTEL LODGE, Permanent with buildings SMALL PARK FOREST RANGER STATION OBSERVATION OR LOOKOUT TOWER CAMP SITE FISH HATCHERY GOLF COURSE OR COUNTRY CLUB ATHLETIC FIELD OR AMUSEMENT PARK FAIRGROUNDS, RACE COURSE DWELLING NUMBER OF DWELLINGS CLOSELY SPACED COMBINED BUSINESS AND DWELLING POST OFFICE POST OFFICE COMBINATIONS 	<ul style="list-style-type: none"> ELEVATION ABOVE SEA LEVEL MOUNTAIN RANGE, BUTTE OR MESA SMALL MONUMENT MARSH OR SWAMP LANDS DRAINAGE DITCH IRRIGATION DITCH LAKE, RESERVOIR OR POND WITH DAM ROAD OVER DAM DRY LAKE SUBJECT TO FLOOD SMALL BRIDGES CLOSELY SPACED HIGHWAY BRIDGE, OVER 20FT. IN LENGTH GENERAL BRIDGE, LONG CROSSING ARCH BRIDGE TRUSS BRIDGE-WOOD-STEEL-CONCRETE CONCRETE DIP OR FORD FORD ROAD ESTABLISHED INTERMITTENT STREAM NARROW STREAM DOCK PIER OR LANDING NAVIGABLE STREAM WITH LOCK & DAM WIDE STREAM OR RIVER TRIANGULATION STATION 	<ul style="list-style-type: none"> SEASONAL DWELLINGS CHURCH OR OTHER RELIGIOUS BUILDING CEMETERY CHURCH WITH CEMETERY ADJACENT REST HOME HOSPITAL SMALL BUSINESS INDUSTRY SAW MILL MINE SHAFT OR DRIFT OIL OR GAS FIELD GAUGING OR PUMPING STATION WAREHOUSE GRAVEL PIT QUARRY SCHOOL COMMUNITY HALL OR LODGE DRIVE-IN THEATER CORRECTIONAL INSTITUTION HIGHWAY GARAGE WAREHOUSE JUNK YARD & SCRAP A-Automobile B-Scrap Building Material D-Refuse Garbage or Trash Dump F-Sanitary Fill, C-Other SEWAGE DISPOSAL PLANT WATER SUPPLY STAND PIPE POWER PLANT BOOSTER STATION POWER SUBSTATION TELEVISION OR RADIO STATION MILITARY INSTALLATION
---	--	--	---

ALL DATA CURRENT TO DATE OF INVENTORY JANUARY 1984
ORIGINAL DRAFTING BY R.G.R., APRIL 1986
STATE SYSTEM REVISED TO AUGUST 1999

GENERAL HIGHWAY MAP
WOODWARD COUNTY
OKLAHOMA

PREPARED BY THE
OKLAHOMA DEPARTMENT OF TRANSPORTATION
PLANNING DIVISION

IN COOPERATION WITH THE
U.S. DEPARTMENT OF TRANSPORTATION
FEDERAL HIGHWAY ADMINISTRATION

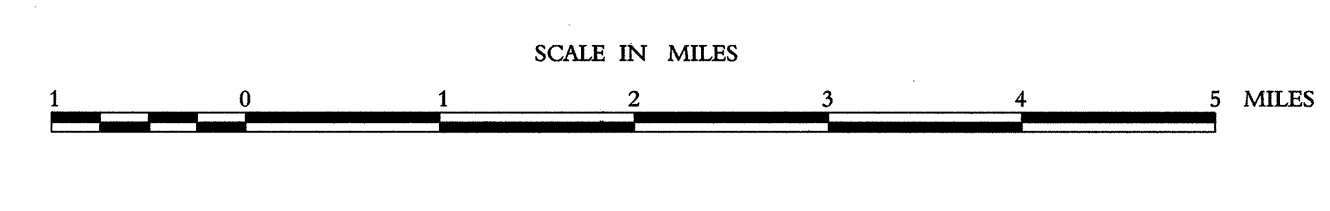

LAMBERT CONFORMAL CONIC PROJECTION U.S. & GEODETIC SURVEY DATA
20,000 FOOT GRID; OKLAHOMA PLANE COORDINATE SYSTEM NORTH PROJECTION ZONE
POPULATION FIGURES BASED ON 1990 U.S. CENSUS
CO. POP. 18,974

ALL RIGHTS RESERVED COMPUTER GENERATED

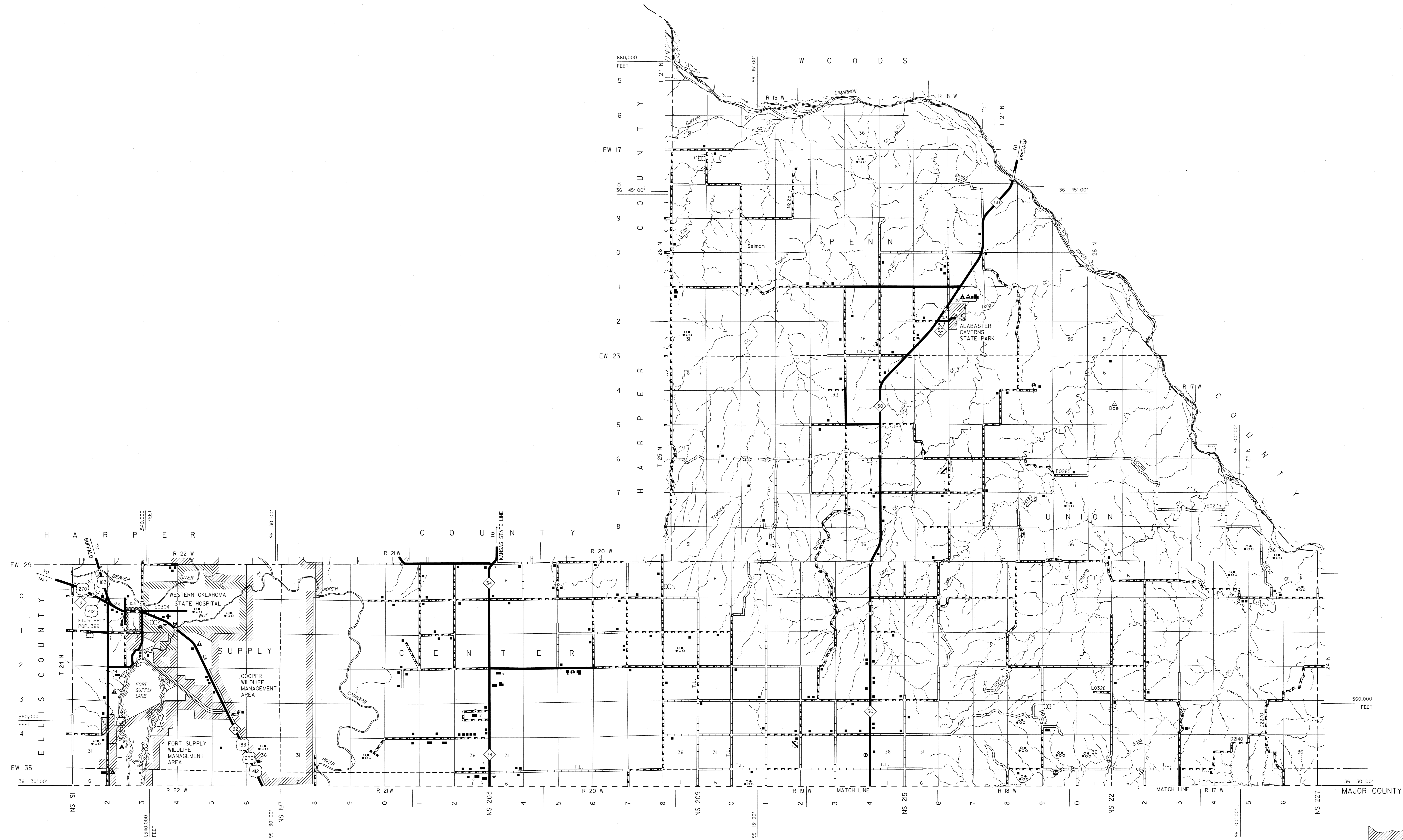

This map indicates those roads known to the Department to be open to public travel. Placement of a road on the map has no relationship to maintenance responsibility by any level of government.
 Copies of this map are available for public use at nominal cost.
 Address:
 OKLAHOMA DEPARTMENT OF TRANSPORTATION
 REPRODUCTION BRANCH Phone (405) 521-2586
 200 N.E. 21st STREET
 OKLAHOMA CITY, OKLAHOMA 73105-3204

ALL DATA CURRENT TO
 DATE OF INVENTORY
 JANUARY 1994
 ORIGINAL DRAFTING BY R.G.A. APRIL 1996
 STATE SYSTEM REVISED TO AUGUST 1999

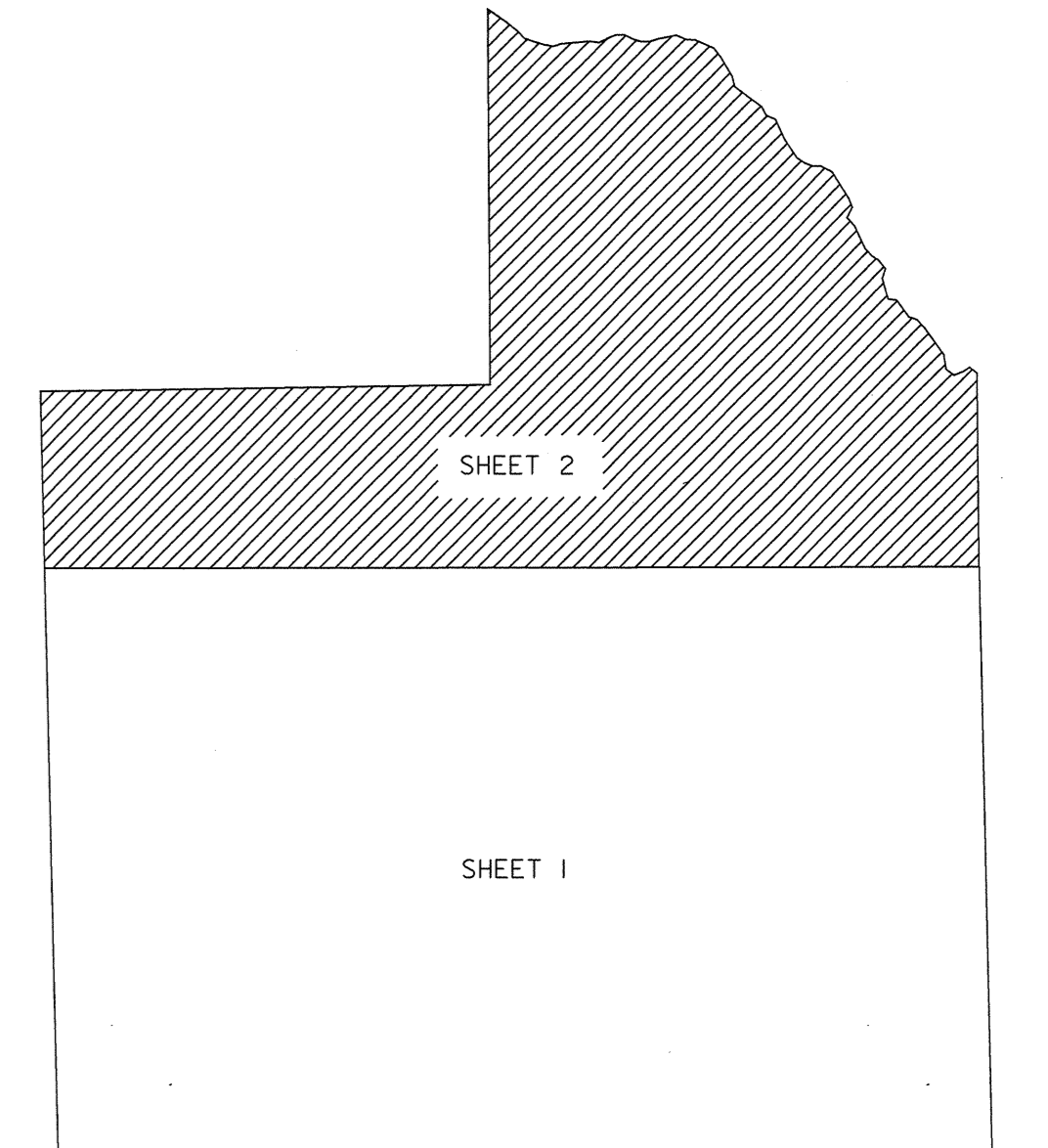
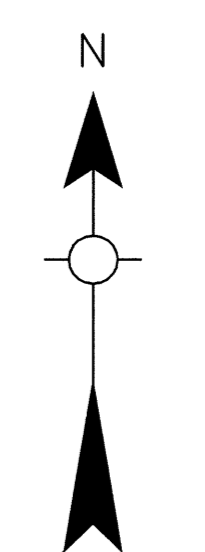

ALL RIGHTS RESERVED SHEET 2 OF 2 SHEETS COMPUTER GENERATED