

LEGEND

- RAILROAD, ANY NUMBER OF TRACKS
- RAILROAD WITH STATION INDICATED
- GRADE CROSSING
- UNDERPASS, & ABOVE
- OVERPASS, & BELOW
- RAILROAD ON STREET
- MILITARY AIRFIELD
- AIRPORT WITH COMPLETE FACILITIES
- AIRPORT WITH LIMITED FACILITIES
- LANDING STRIP, PRIVATE FIELD
- AIRPORT, GENERAL OUTLINE OF FIELD
- RUNWAYS SHOWN IN POSITION
- ROADSIDE PARK Public Grounds
- RANGELANDS
- BATHING BEACH OR SWIMMING POOL
- CAMP OR LODGE, Permanent with buildings
- SCENIC SITE
- WATER TOWER
- SHALL PARK SP-3000, CA-County
- FOREST RANGER STATION
- OBSERVATION OR LOOKOUT TOWER
- CAMP SITE
- RSH HATCHERY
- DOG CLUBS OR COUNTRY CLUB
- ATHLETIC FIELD OR AMUSEMENT PARK
- PARKLANDS, RACE COURSE
- DWELLING NUMBER OF DWELLINGS CLOSELY SPACED
- COMBINED BUSINESS AND DWELLING
- POST OFFICE
- POST OFFICE COMBINATIONS
- SEASONAL DWELLINGS
- CHURCH OR OTHER RELIGIOUS BUILDING
- CEMETERY
- CHURCH WITH CEMETERY ADJACENT
- REST HOME
- HOSPITAL
- SMALL BUSINESS
- INDUSTRY
- SAW MILL
- MINE SHAFT OR DRIFT
- OIL OR GAS FIELD
- QUARRY OR PAVING STATION
- WAREHOUSE
- DRAWING
- SCHOOL
- COMMUNITY HALL OR LODGE
- DRIVE-IN THEATER
- CONVENTIONAL INSTITUTION
- HIGHWAY GRADE
- JUNK YARDS & DUMPS A-Airborne, B-Building, C-Corner, D-Mobile, Garbage or trash dump, E-Industry, F-Fuel, G-Gas
- SEWAGE DISPOSAL PLANT
- WATER SUPPLY STAND PIPE
- POWER PLANT
- BOILER STATION
- POWER SUBSTATION
- TELEVISION OR RADIO STATION
- METEOROLOGICAL STATION

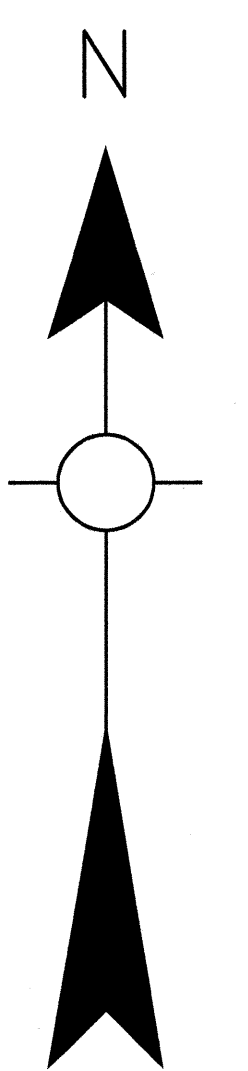
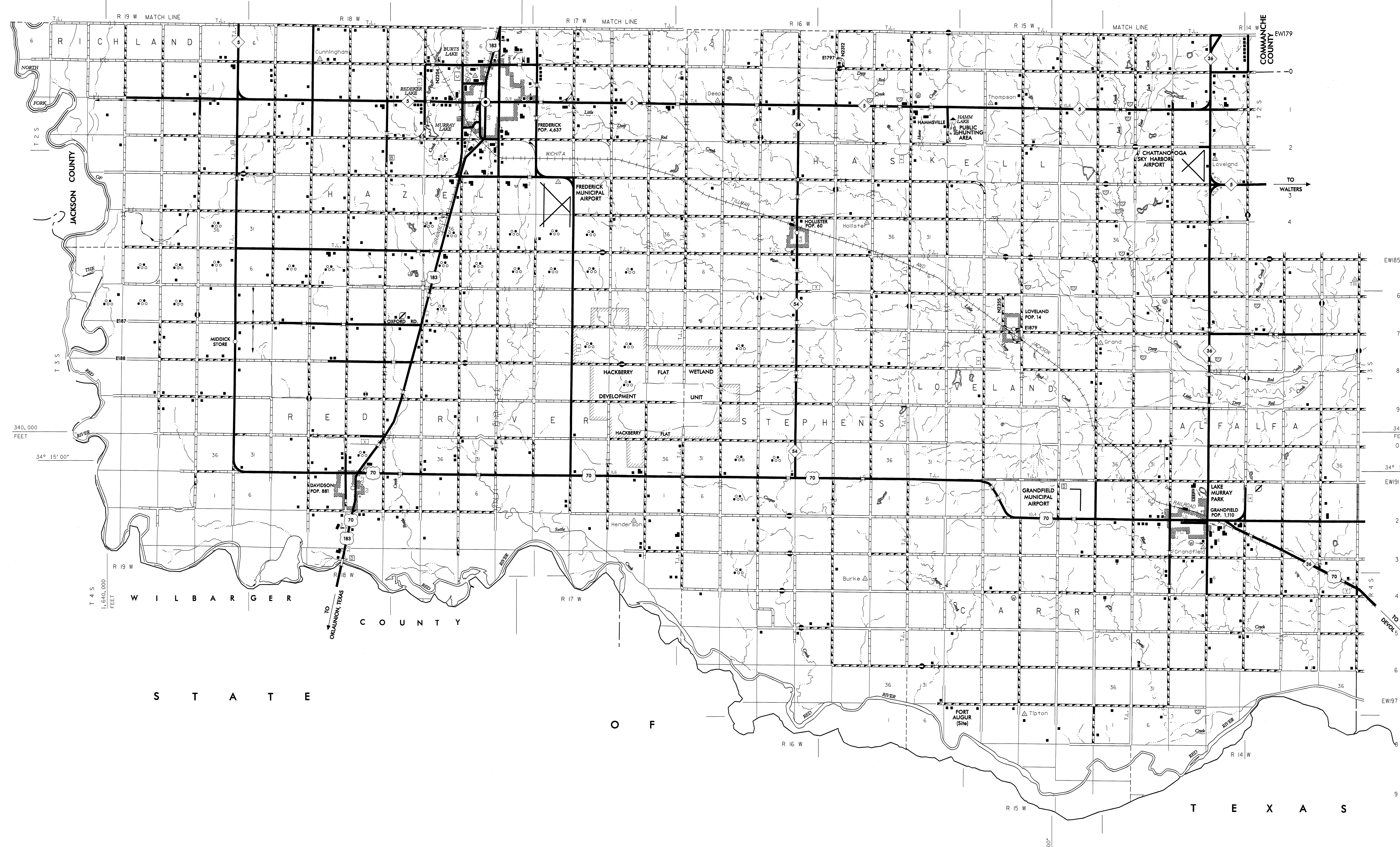

GENERAL HIGHWAY MAP
TILLMAN COUNTY
 OKLAHOMA

PREPARED BY THE
 OKLAHOMA DEPARTMENT OF TRANSPORTATION
 PLANNING DIVISION

IN COOPERATION WITH THE
 U.S. DEPARTMENT OF TRANSPORTATION
 FEDERAL HIGHWAY ADMINISTRATION

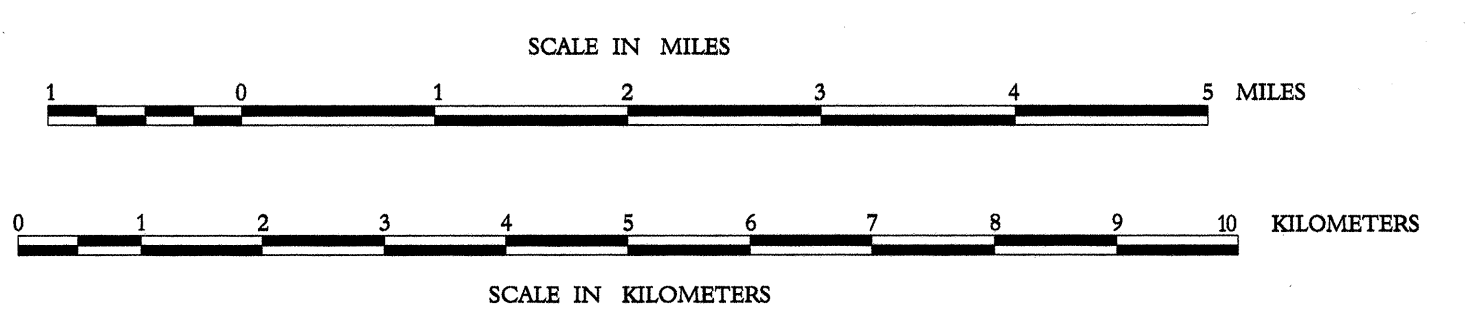

ALL DATA CURRENT TO
 DATE OF INVENTORY
 AUGUST 2000
 ORIGINAL DRAWING BY JAN. AUGUST 2002
 STATE SYSTEM REVISED TO AUGUST 2002

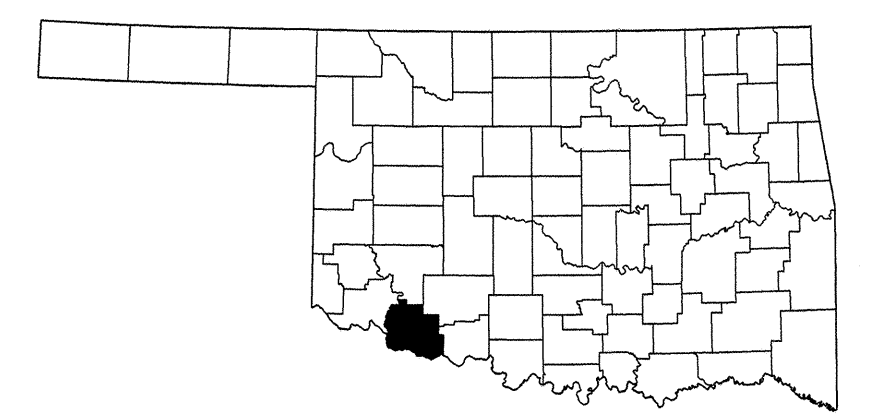

Copies of this map are available for public use at nominal cost.
 Address: OKLAHOMA DEPARTMENT OF TRANSPORTATION
 PRINTING SERVICES PHONE (405) 521-2586
 200 N.E. 21st STREET
 OKLAHOMA CITY, OKLAHOMA 73105-3204

This map indicates those roads known to the Department to be open to public travel. Placement of a road on the map has no relationship to maintenance responsibility by any level of government.

SHEET 1 OF 2 SHEETS

NOT FOR RESALE

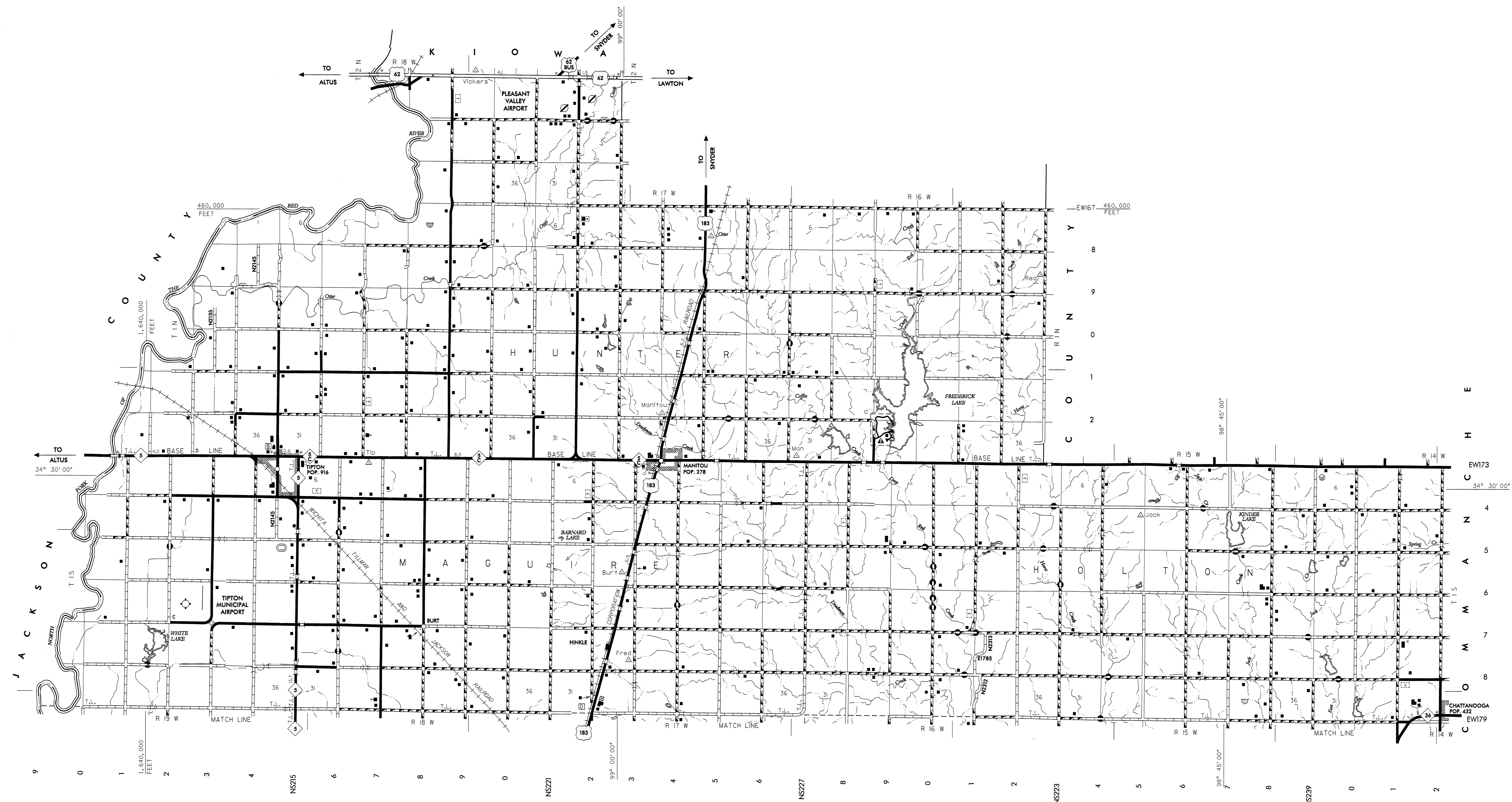

Copies of this map are available for public use at nominal cost. This map indicates those roads known to the Department to be open to public travel. Placement of a road on the map has no relationship to maintenance responsibility by any level of government.

Address:
 OKLAHOMA DEPARTMENT OF TRANSPORTATION
 PRINTING SERVICES Phone (405) 521-2586
 200 N.E. 7th STREET
 OKLAHOMA CITY, OKLAHOMA 73105-3204

