

COUNTY
 8
 EW029
 580,000
 0
 1
 2
 3
 4
 5
 EW035
 36° 30' 00"
 6
 7
 8
 9
 0
 EW041
 2
 3
 4
 5
 6
 7
 8
 9
 0
 EW047
 1
 2
 3
 4
 5
 6
 7
 8
 9
 0
 EW053
 36° 15' 00"
 4
 5
 6
 7
 8
 9
 0
 EW059
 440,000
 FEET
 TULSA
 TULSA COUNTY
 TULSA POP. 361,302
 OSAGE 5,674
 TULSA 50,628
 TULSA CO. 5,015
 SAND SPRING POP. 6,346
 OSAGE CO. 336
 TULSA CO. 5,015

LEGEND

	U.S. NUMBERED HIGHWAY		RAILROAD, ANY NUMBER OF TRACKS
	STATE NUMBERED HIGHWAY		GRADE CROSSING
	INTERSTATE HIGHWAY ROUTE		UNDERPASS, R.R. ABOVE
	PAVED ROAD		OVERPASS, R.R. BELOW
	GRADED & DRAINED ROAD		RAILROAD ON STREET
	UNIMPROVED ROAD		MILITARY AIRFIELD
	PRIMITIVE ROAD		AIRPORT WITH COMPLETE FACILITIES
	PROJECTED ROAD		AIRPORT WITH LIMITED FACILITIES
	RESIDENTIAL ROAD		LANDING STRIP, PRIVATE FIELD
	COUNTY ROAD ID NO.		AIRPORT, GENERAL OUTLINE OF FIELD
	MILEAGE BETWEEN POINTS		RUNWAYS SHOWN IN POSITION
	DIVIDED HIGHWAY, 4 OR MORE LANES		ROADSIDE PARK Picnic Grounds
	DIVIDED HIGHWAY, 3 OR MORE LANES		BATHING BEACH OR SWIMMING POOL
	TRAFFIC CIRCLE		SCENIC SITE
	HIGHWAY GRADE SEPARATION		CAMP OR LODGE, Permanent with buildings
	TRAFFIC INTERCHANGE		MOTEL
	STATE LINE		SMALL PARK SP-State, CP-County
	CIVIL TOWNSHIP LINE		MP-Multipole, TP-Trailer Park
	SECTION LINE		FOREST RANGER STATION
	RURAL DEVELOPMENT AREA		OBSERVATION OR LOOKOUT TOWER
	GOVERNMENT PROPERTY LINE		CAMP SITE
	MATCH LINE		FISH HATCHERY
	COUNTY SEAT		GOLF COURSE OR COUNTRY CLUB
	CORPORATE LIMITS		ATHLETIC FIELD OR AMUSEMENT PARK
	CIVIL TOWNSHIP, ROAD IN PLACE		FAIRGROUNDS, RACE COURSE
	INSET BOUNDARY		DWELLING
	ELEVATION ABOVE SEA LEVEL		NUMBER OF DWELLINGS CLOSELY SPACED
	MOUNTAIN RANGE, BUTTE OR MESA		COMBINED BUSINESS AND DWELLING
	SMALL MONUMENT		POST OFFICE
	MARSH OR SWAMP LANDS		POST OFFICE COMBINATIONS
	DRAINAGE DITCH		SEASONAL DWELLINGS
	IRRIGATION DITCH		CHURCH OR OTHER RELIGIOUS BUILDING
	ROAD OVER DAM		CEMETERY
	LAKE, RESERVOIR OR POND WITH DAM		CHURCH WITH CEMETERY ADJACENT
	DRY LAKE SUBJECT TO FLOOD		REST HOME
	SMALL BRIDGES CLOSELY SPACED		HOSPITAL
	HIGHWAY BRIDGE, OVER 20FT. IN LENGTH		SMALL BUSINESS
	GENERAL BRIDGE, LONG CROSSING		INDUSTRY
	ARCH BRIDGE		SAW MILL
	TRUSS BRIDGE, W-WOOD, S-STEEL, C-CONCRETE		MINE SHAFT OR DRIFT
	CONCRETE DIP OR FORD		OIL OR GAS FIELD
	FORD ROAD ESTABLISHED		GAUGING OR PUMPING STATION
	INTERMITTENT STREAM		WAREHOUSE
	NARROW STREAM		GRAVEL PIT
	DOCK PIER OR LANDING		QUARRY
	NAVIGABLE STREAM WITH LOCK & DAM		SCHOOL
	WIDE STREAM OR RIVER		COMMUNITY HALL OR LODGE
	TRIANGULATION STATION		DRIVE-IN THEATER
			CORRECTIONAL INSTITUTION
			HIGHWAY GARAGE
			JUNK YARDS & DUMPS A-Automobile, B-Scrap Building Material, C-Other
			SEWAGE DISPOSAL PLANT
			WATER SUPPLY STAND PIPE
			POWER PLANT
			BOOSTER STATION
			POWER SUBSTATION
			TELEVISION OR RADIO STATION
			MILITARY INSTALLATION

ALL DATA CURRENT TO
 DATE OF INVENTORY
 MARCH 1995
 ORIGINAL DRAFTING BY W.A.T. MAY 1996
 STATE SYSTEM REVISED TO MAY 1996

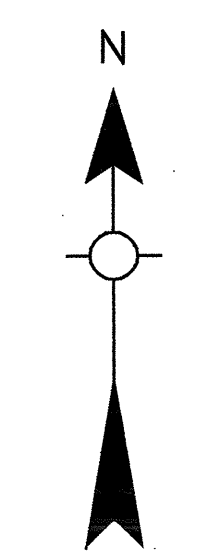
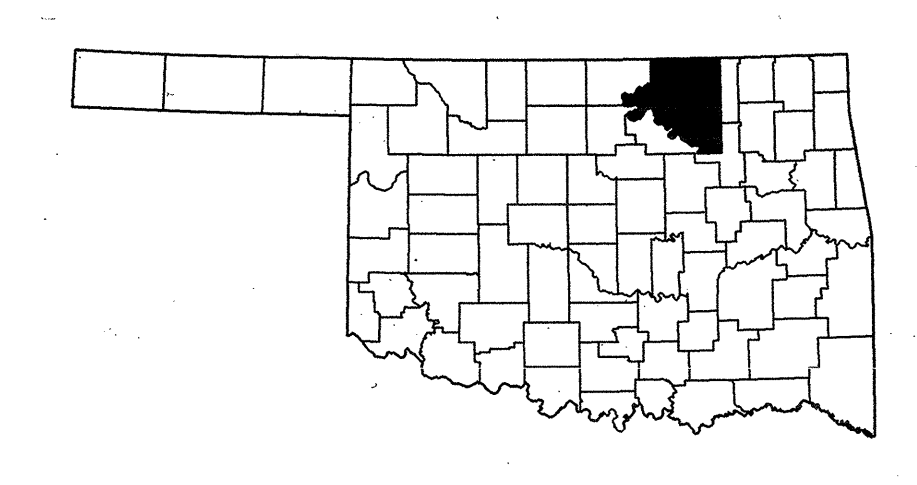

**GENERAL HIGHWAY MAP
 OSAGE COUNTY
 OKLAHOMA**

PREPARED BY THE
**OKLAHOMA DEPARTMENT OF TRANSPORTATION
 PLANNING DIVISION**

IN COOPERATION WITH THE
**U.S. DEPARTMENT OF TRANSPORTATION
 FEDERAL HIGHWAY ADMINISTRATION**

SCALE
 0 1 2 3 4 5 6 MILES
 LAMBERT CONFORMAL CONIC PROJECTION U.S. & GEODETIC SURVEY DATA
 20,000 FOOT GRID OKLAHOMA PLANE COORDINATE SYSTEM NORTH PROJECTION ZONE,
 POPULATION FIGURES BASED ON 1990 U.S. CENSUS
 CO. POP. 41,445

ALL RIGHTS RESERVED SHEET 1 OF 4 SHEETS COMPUTER GENERATED

This map indicates those roads known to the Department to be open to public travel. Placement of a road on the map has no relationship to maintenance responsibility by any level of government.
 Copies of this map are available for public use at nominal cost.
 A004888
 OKLAHOMA DEPARTMENT OF TRANSPORTATION
 REPRODUCTION BRANCH Phone (405) 521-2586
 200 N.E. 26th STREET
 OKLAHOMA CITY, OKLAHOMA 73105-3204

NOT FOR RESALE

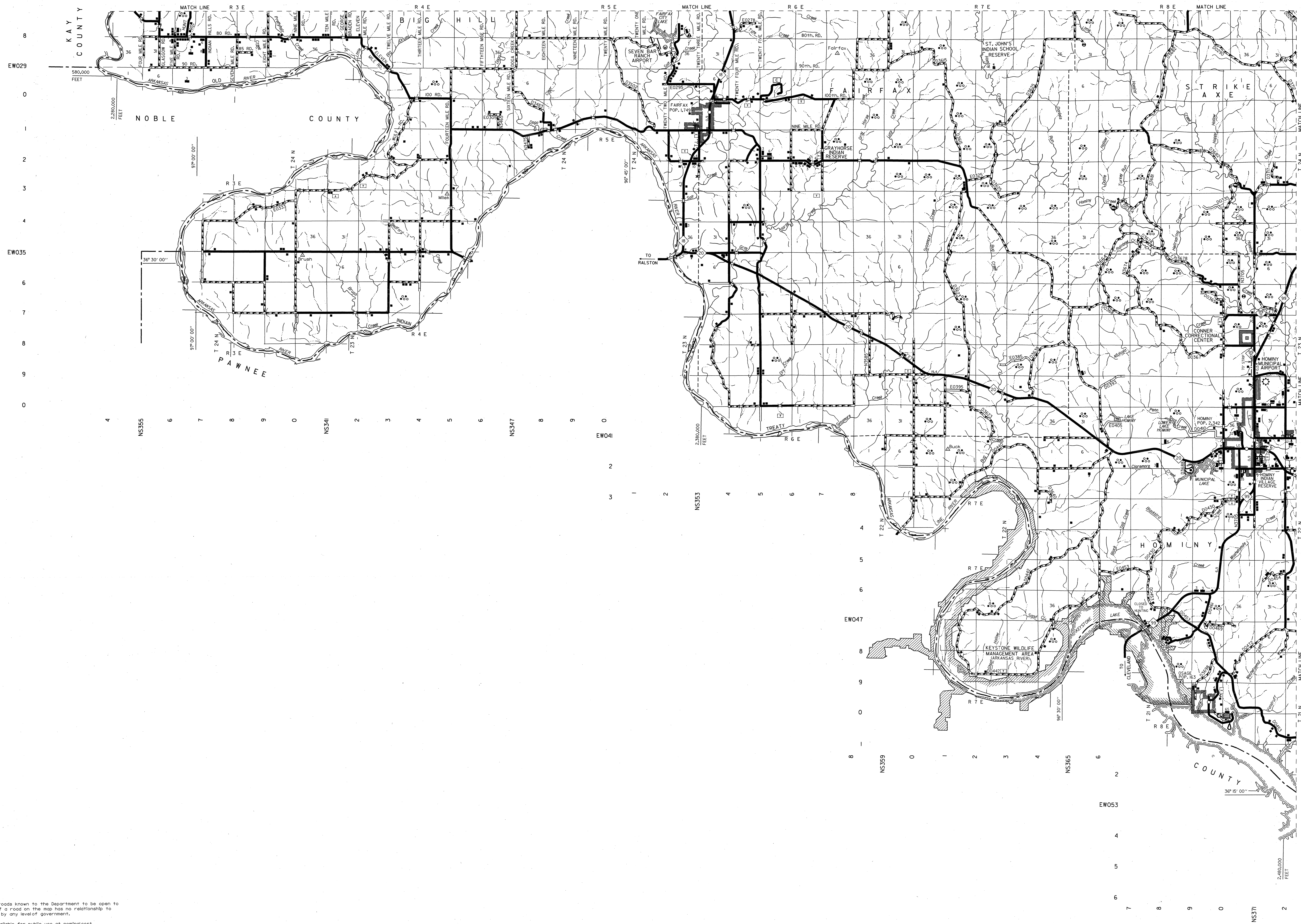

This map indicates those roads known to the Department to be open to public travel. Placement of a road on the map has no relationship to maintenance responsibility by any level of government.

Copies of this map are available for public use at nominal cost.

Address:
 OKLAHOMA DEPARTMENT OF TRANSPORTATION
 REPRODUCTION BRANCH Phone (405) 521-2586
 200 N.E. 26th STREET
 OKLAHOMA CITY, OKLAHOMA 73105-3204

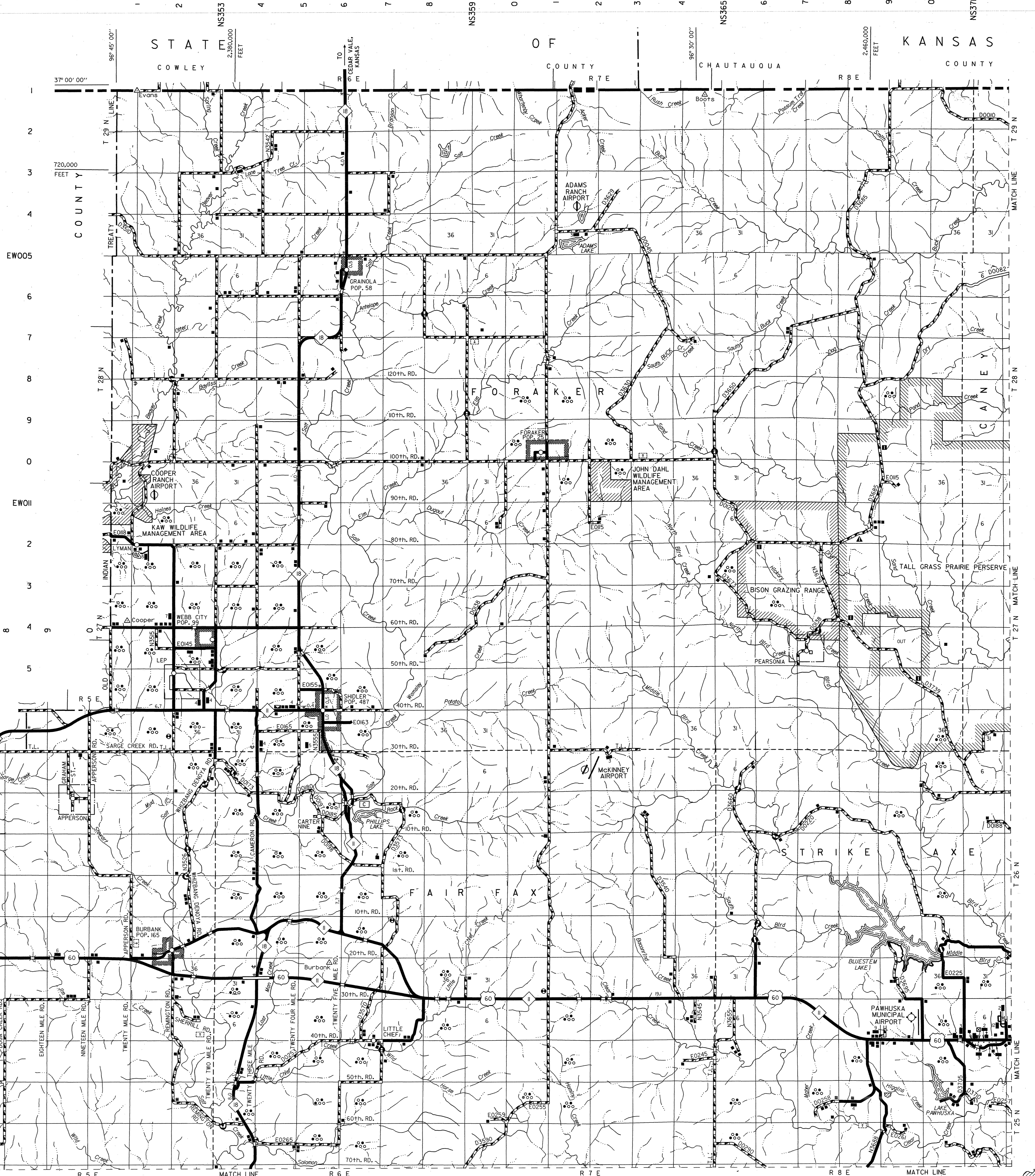
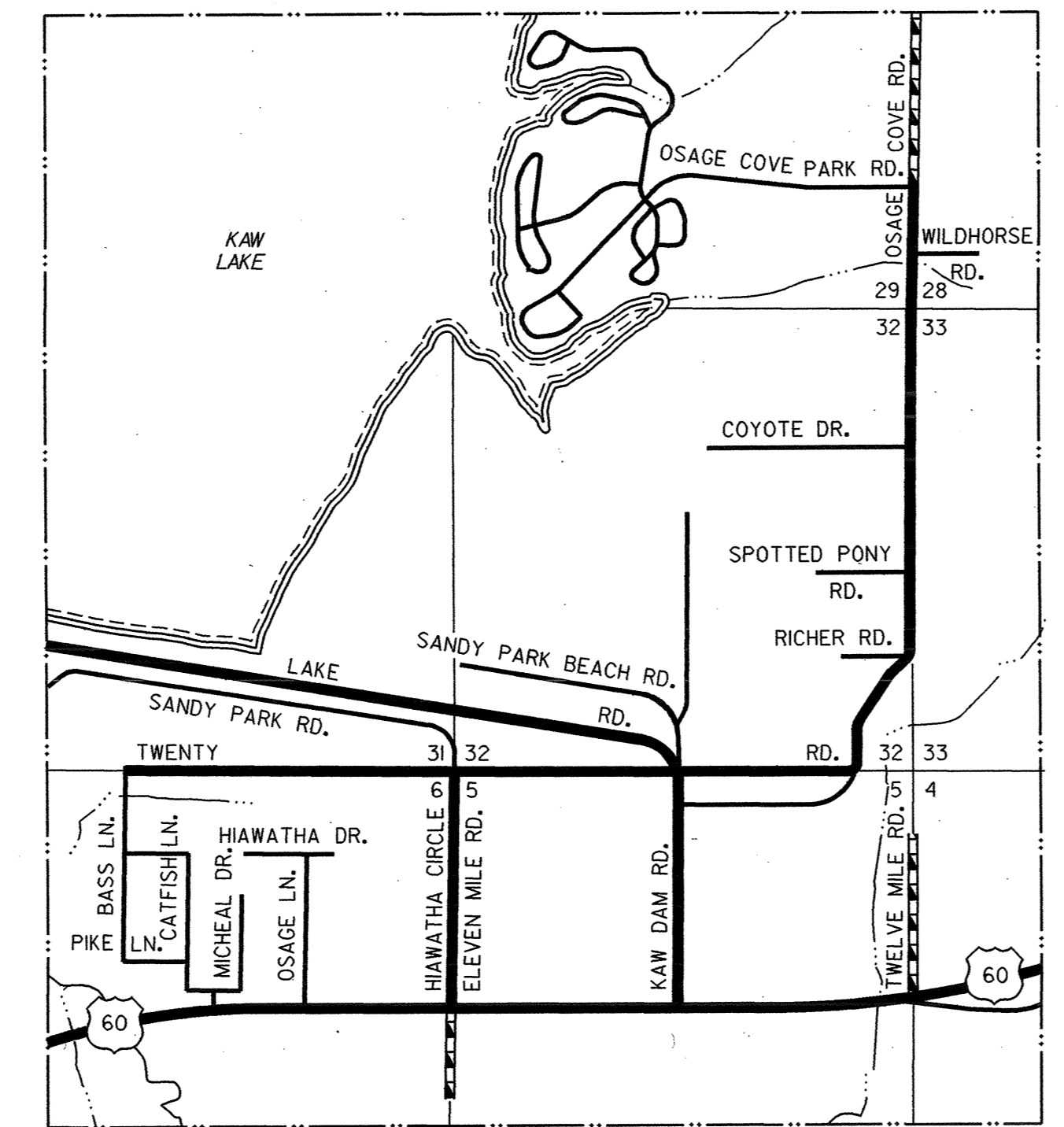
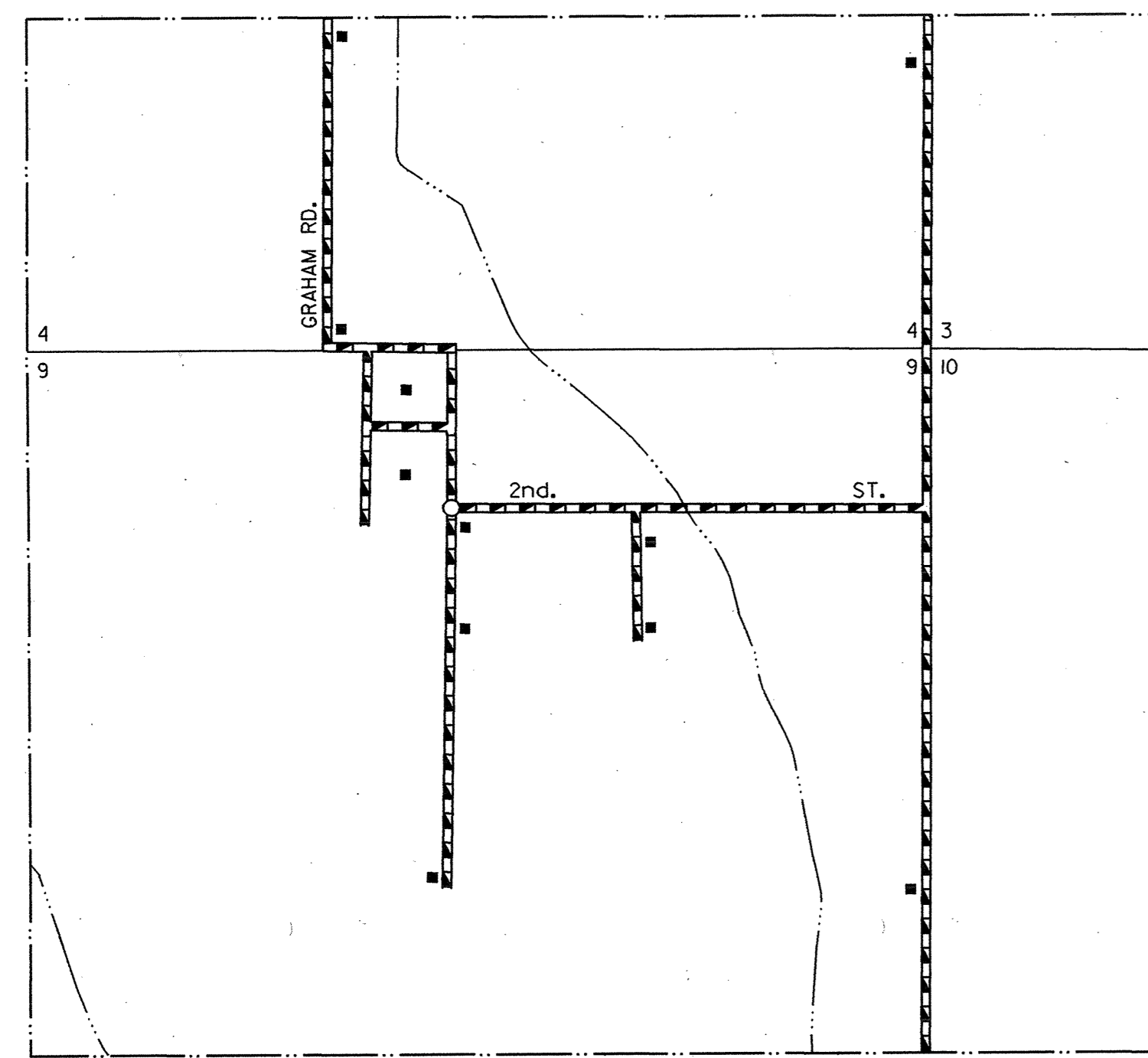
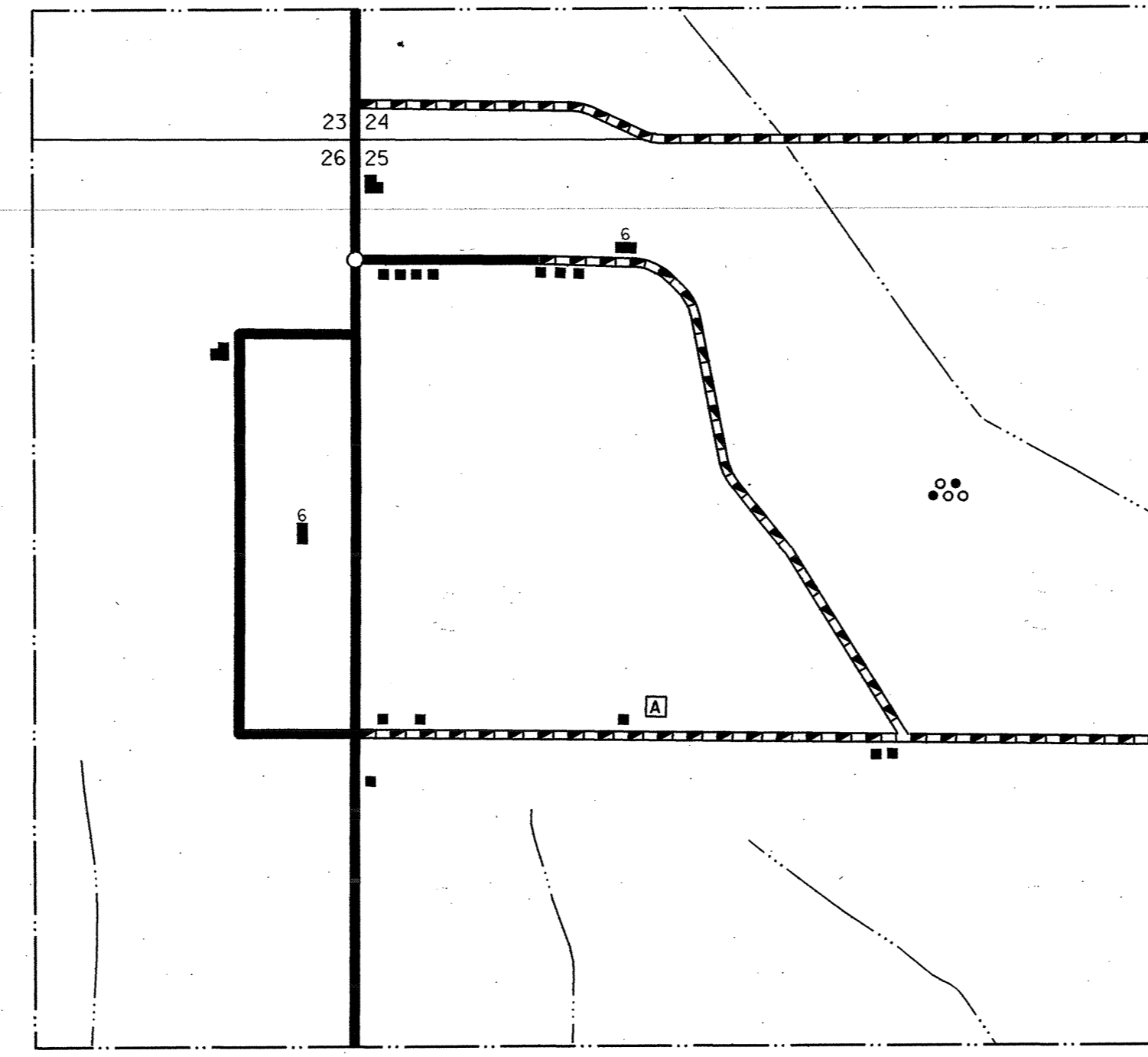
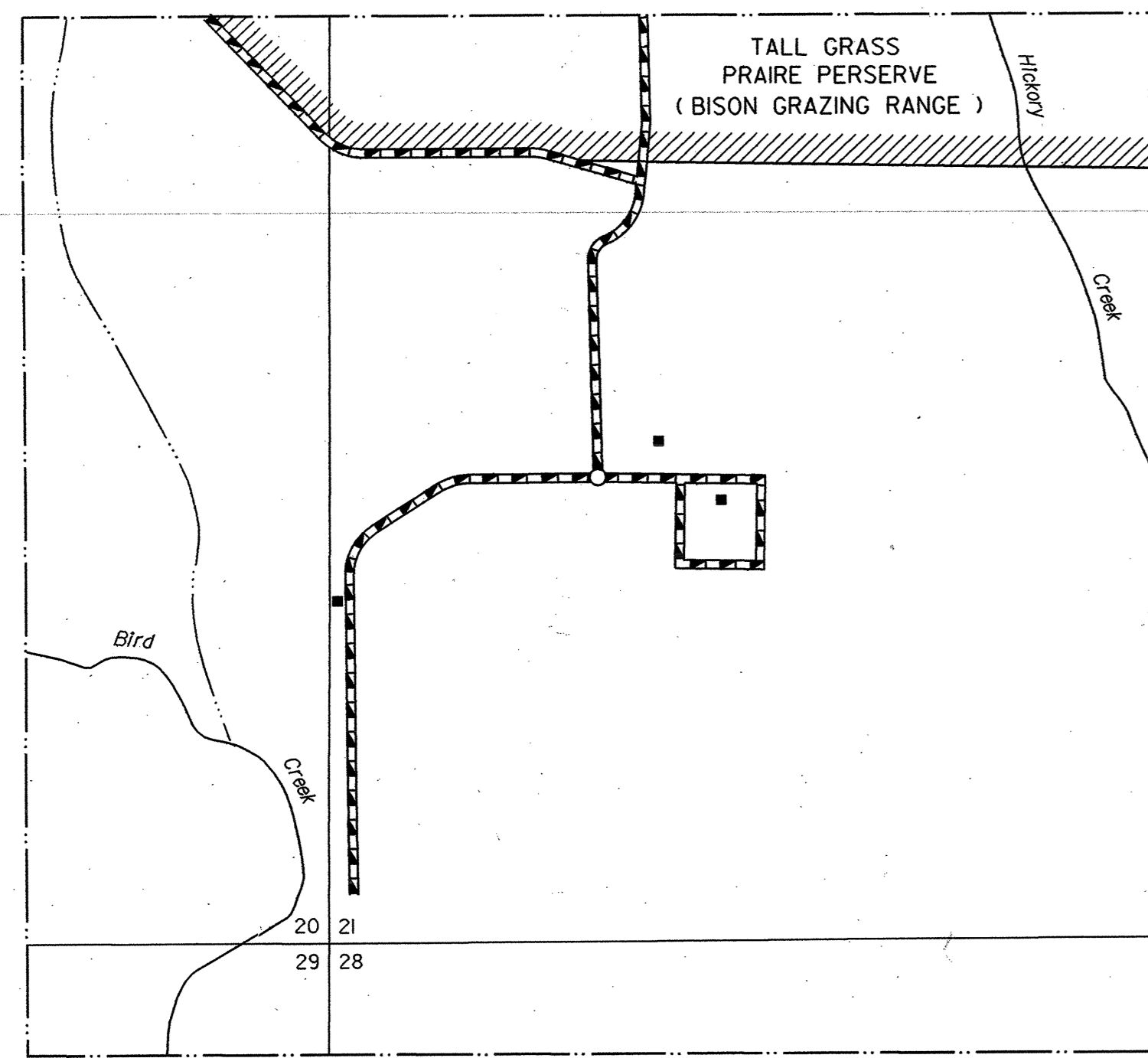

This map indicates those roads known to the Department to be open to public travel. Placement of a road on the map has no relationship to maintenance responsibility by any level of government.
Copies of this map are available for public use at nominal cost.
4507-8881
OKLAHOMA DEPARTMENT OF TRANSPORTATION
REPRODUCTION BRANCH Phone 405/521-2546
200 N.E. 21st STREET
OKLAHOMA CITY, OKLAHOMA 73105-3204

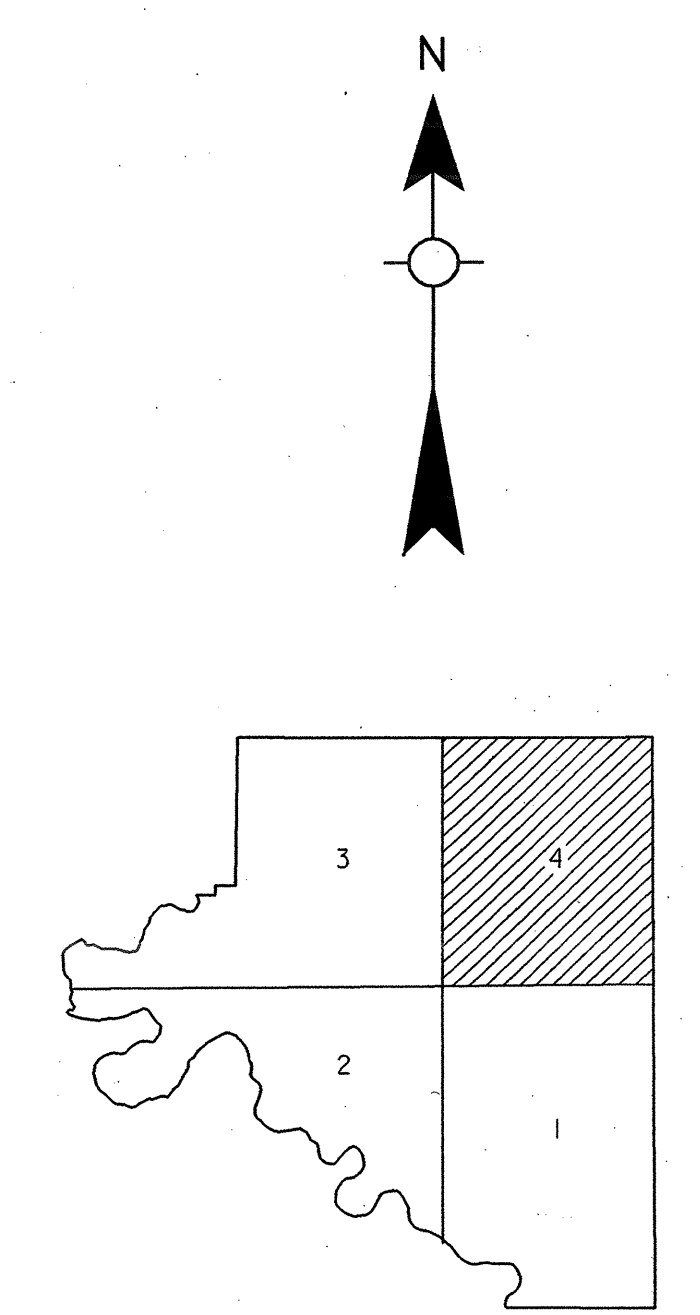
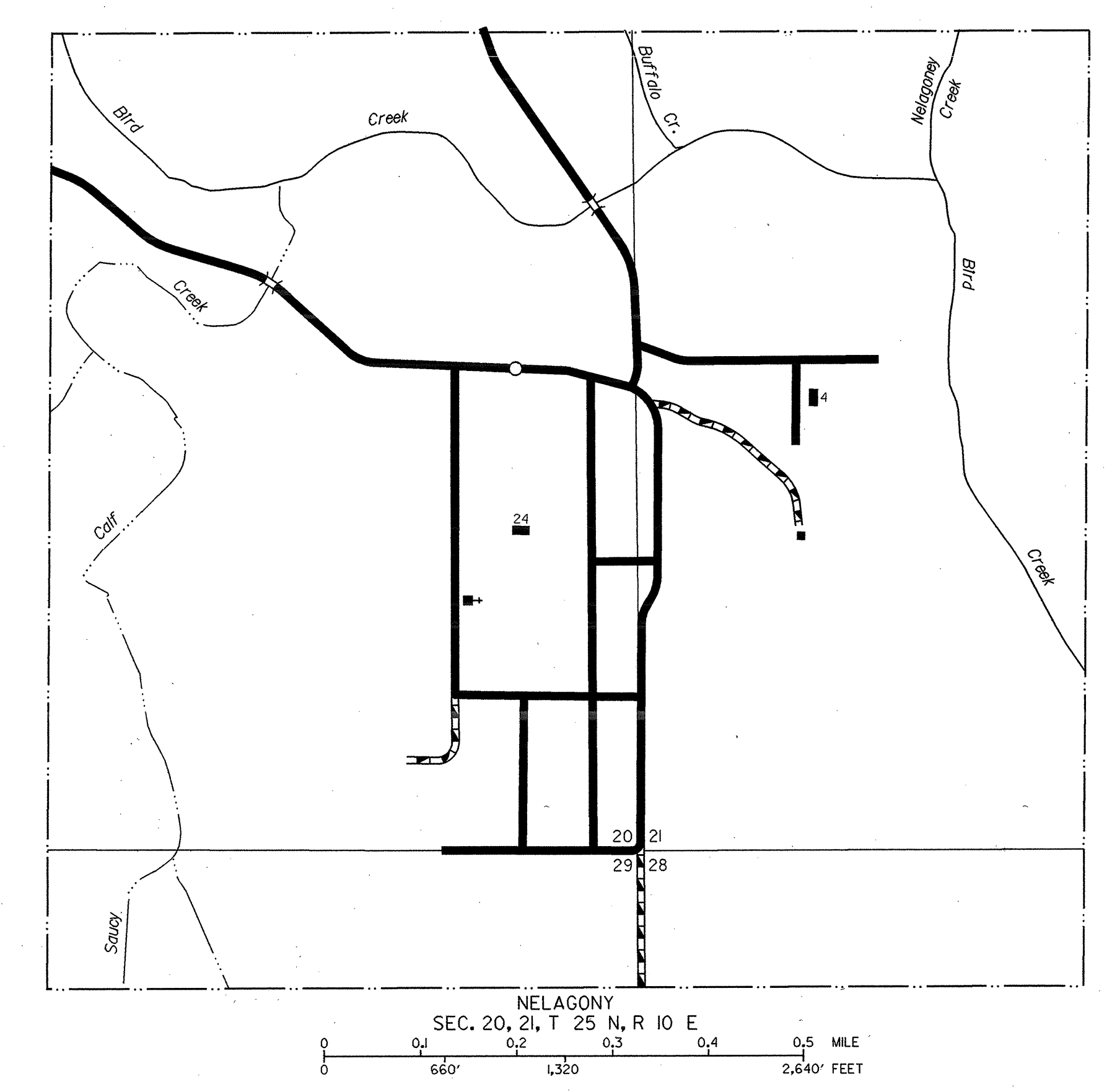
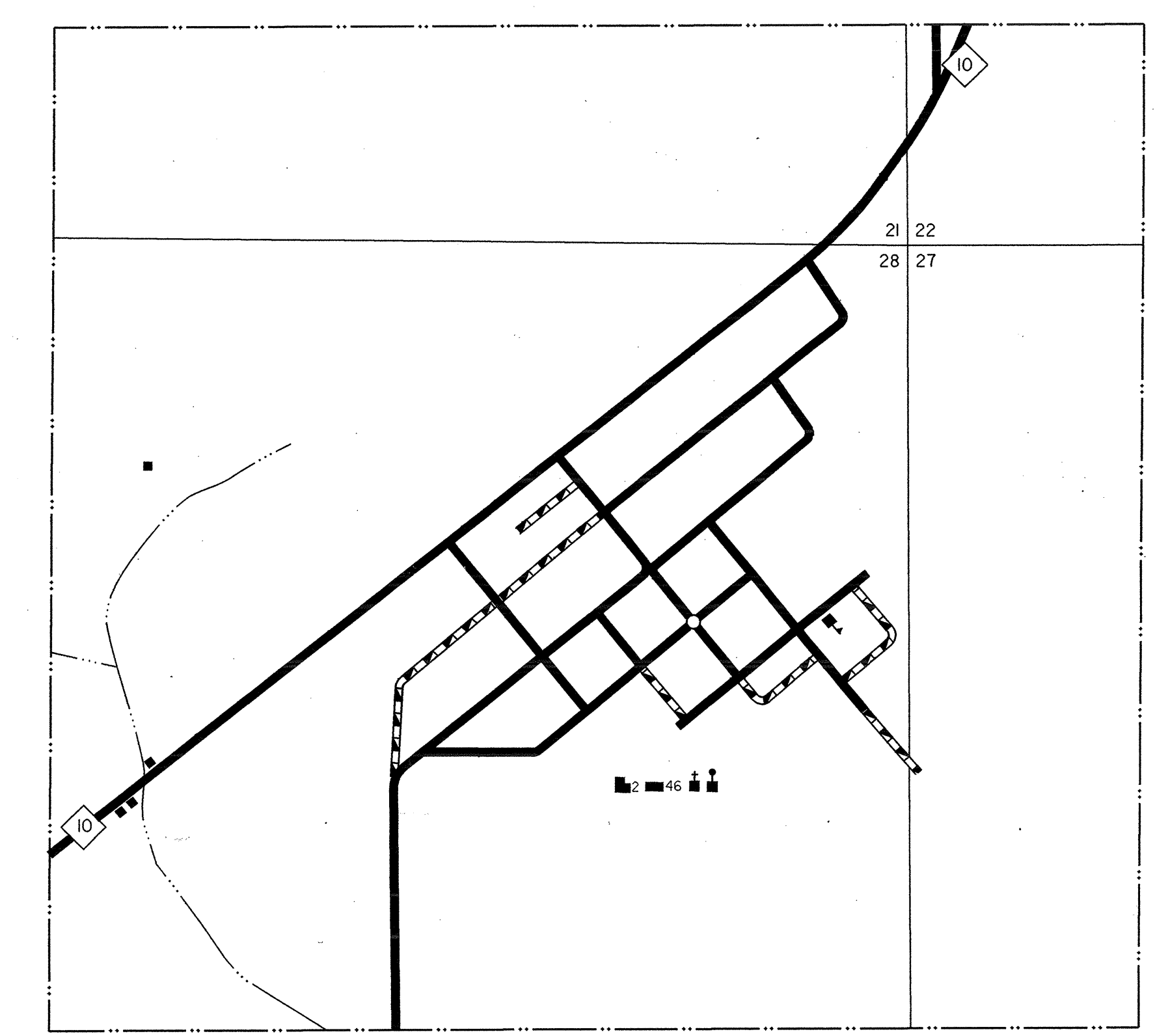
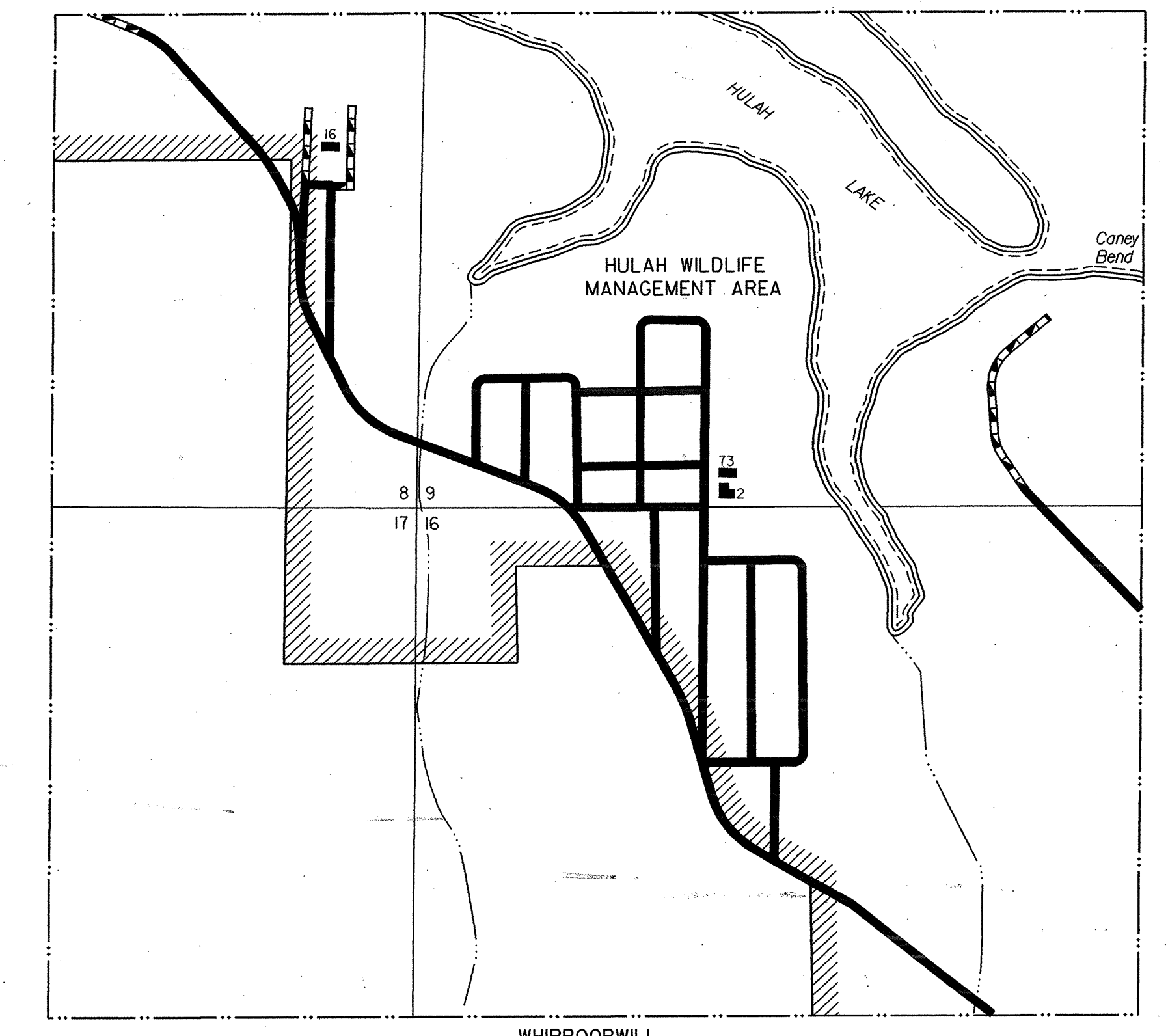
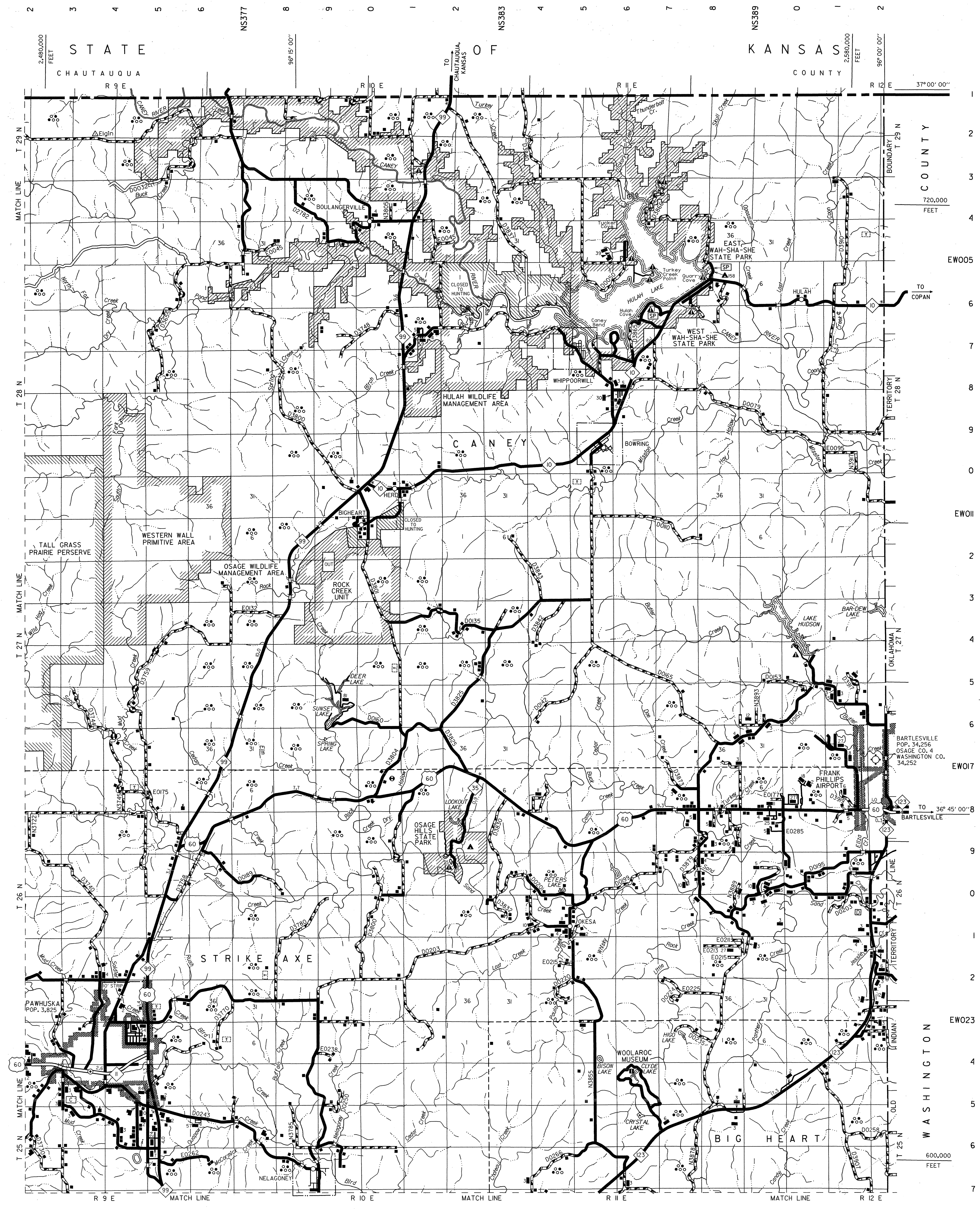

This map indicates those roads known to the Department to be open to public travel. Placement of a road on the map has no relationship to maintenance responsibility by any level of government.

Copies of this map are available for public use at nominal cost.

Address:
 OKLAHOMA DEPARTMENT OF TRANSPORTATION
 REPRODUCTION BRANCH Phone (405) 521-2586
 200 N.E. 24th STREET
 OKLAHOMA CITY, OKLAHOMA 73105-3204